

# HVE 03

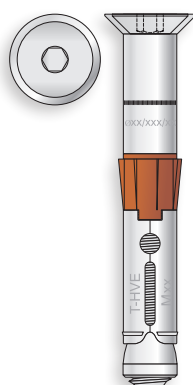

- High performance steel anchor with 8.8 grade Flat CSK head Hex recess screw, with PATENTED design, zinc plated, Certified ETA-CE Option 1 and Performance Category C1 Under Seismic Action**
- Cheville haute performances en acier zingué avec vis tête fraisée plate classe 8.8, avec géométries brevetées, avec certification ETE-CE Option 1 et catégorie de performance C1 en zone sismique
- Verzinkter Hochleistungs- Schwerlastanker mit Senkkopfschraube Klasse 8.8, mit ETB-CE Zulassung Option 1 und seismische Leistungskategorie C1
- Anclaje de acero cincado para Altas Prestaciones, montado con tornillo cabeza avellanada con hueco hexagonal clase 8.8, con geometrías PATENTADAS, Homologada ETA-CE Opción 1 y Categoría de prestación C1 para fijaciones en zonas sísmicas
- Высокоэффективный стальной оцинкованный анкер с винтом с потайной головкой класса прочности 8.8 с внутренним шестигранником, Сертифицирован ETA-CE Опция 1 и Категория C1 для сейсмических воздействий



Item code	Anchor size $\varnothing \times L_a / t_{fix}$ (mm)	Screw size M	Pcs. per box	Pcs. per carton
<b>Ø 10 - M6 - In-Hex 4</b>				
<b>HVE 03 10 085</b>	10 x 85 / 20	M6	50	500
<b>HVE 03 10 105</b>	10 x 105 / 40	M6	50	500
<b>HVE 03 10 125</b>	10 x 125 / 60	M6	50	250
<b>Ø 12 - M8 - In-Hex 5</b>				
<b>HVE 03 12 085</b>	12 x 85 / 15	M8	50	250
<b>HVE 03 12 105</b>	12 x 105 / 35	M8	25	250
<b>HVE 03 12 125</b>	12 x 125 / 55	M8	25	250
<b>Ø 16 - M10 - In-Hex 6</b>				
<b>HVE 03 16 110</b>	16 x 110 / 30	M10	20	100
<b>HVE 03 16 130</b>	16 x 130 / 50	M10	20	100
<b>Ø 18 - M12 - In-Hex 8</b>				
<b>HVE 03 18 120</b>	18 x 120 / 20	M12	10	100
<b>HVE 03 18 140</b>	18 x 140 / 40	M12	10	100

**ETA-CE Option 1 Certified item / Agrément technique européen ATE-CE / ETA-CE Zulassung / Homologación ETA-CE / Сертификация ETA-CE**

**ETAG 001 - ANNEX E (C2 - C1) - Item assessed Under Seismic Action / Article évalué en zone sismique / Artikel mit Bewertung von seismischer Leistungskategorie / Evaluación para fijaciones en zonas sísmicas / Одобрен для сейсмических воздействий**

**R120 Fire Resistance Certified item / Résistance au feu / Feuerwiderstand / Homologación de resistencia al fuego / Сертификат пожаробезопасности**



European Technical Assessment  
ETAG 001 - PART 1 and 2 and ANNEX E  
OPTION 1: for cracked and non-cracked concrete  
Seismic assessment: performance category C2 - C1  
DoP available on [www.tecfi.it/DoP](http://www.tecfi.it/DoP)

Application submitted for an ICC-ES evaluation report covering seismic action in accordance with ACI 355.2.

Usage / Utilisation / Benutzung / Uso / Применение



For through (in-place) heavy duty fixings in cracked and non-cracked concrete, performance Category C2 and C1 for use under seismic action, according to ETAG 001 - ANNEX E.  
Item included in **TADS - Tecfi Anchor Design Software** for computer aided design of Anchorage

Box / Boîte / Verpackung / Caja / Упаковка



Installation sequence / Instructions de mise en oeuvre / Setzanweisung / Secuencia de instalación / Порядок монтажа

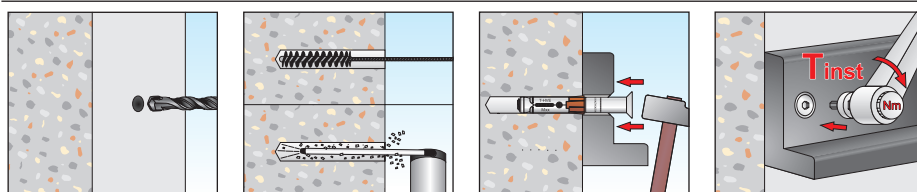

DoP



Declaration of Performance

Related products

108

HXE-CONCRETO® flat CSK head screw



HXE03  
p. 102

Sleeve anchor



DSE07  
p. 114

SDS-PLUS masonry drill



EO  
p. 398

In-hex power bit



FN  
p. 401

Pump for hole cleaning



DW  
p. 164