

The professional choice!

CHEMBOLT

Installation Instructions

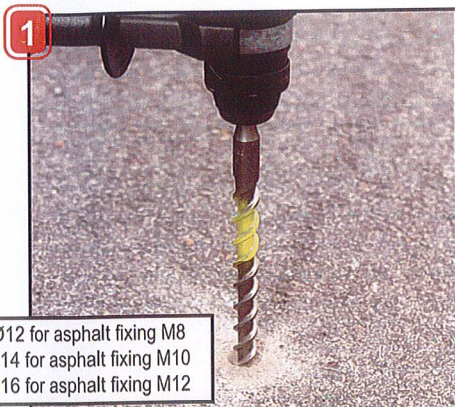

Ø12 for asphalt fixing M8
Ø14 for asphalt fixing M10
Ø16 for asphalt fixing M12

Drill :

- Depth 80 mm for length of 70mm
- Depth 110 mm for length of 100mm



Clean the hole with a push pump. A bad cleaning does considerably reduce the durability and quality of the fixing.

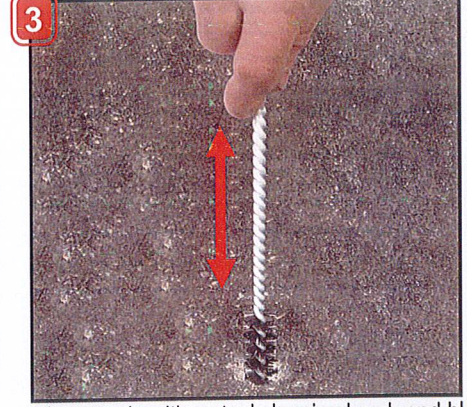

Clean again with a steel cleaning brush and blow off again with a push pump (see picture no.2)



Inject the resin (refer to the fixings indications on the cartridge). Fill the hole by 3/4
We recommend with the use of our resin.

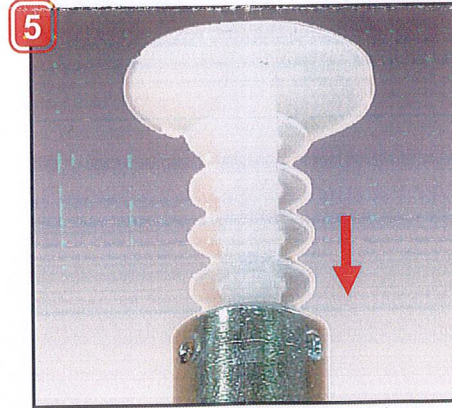

Put the cap into the piece, but do not insert it entirely (in order to protect the internal thread)

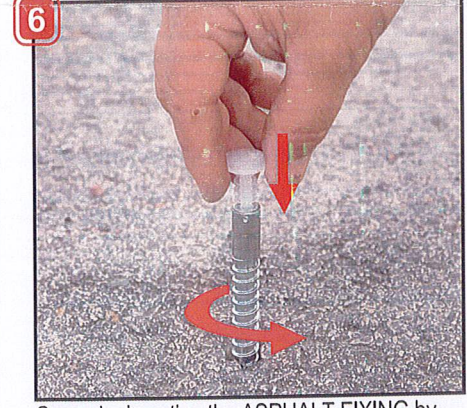

Screw by inserting the ASPHALT FIXING by using the white cap.



Exact position of the cap during the curing time of the resin.



As soon as the resin has hardened, remove the white cap.

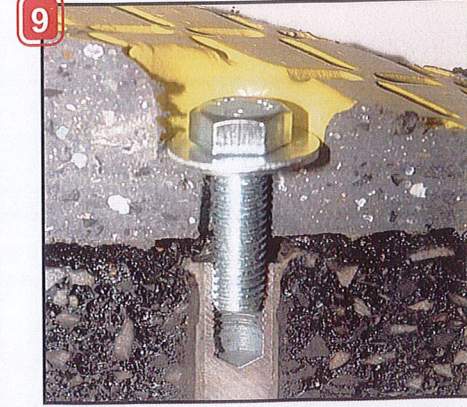

Place the piece to be fixed and tighten with the metal hexagon screw.